

ZVA SLIMLINE (production until 12.2008)

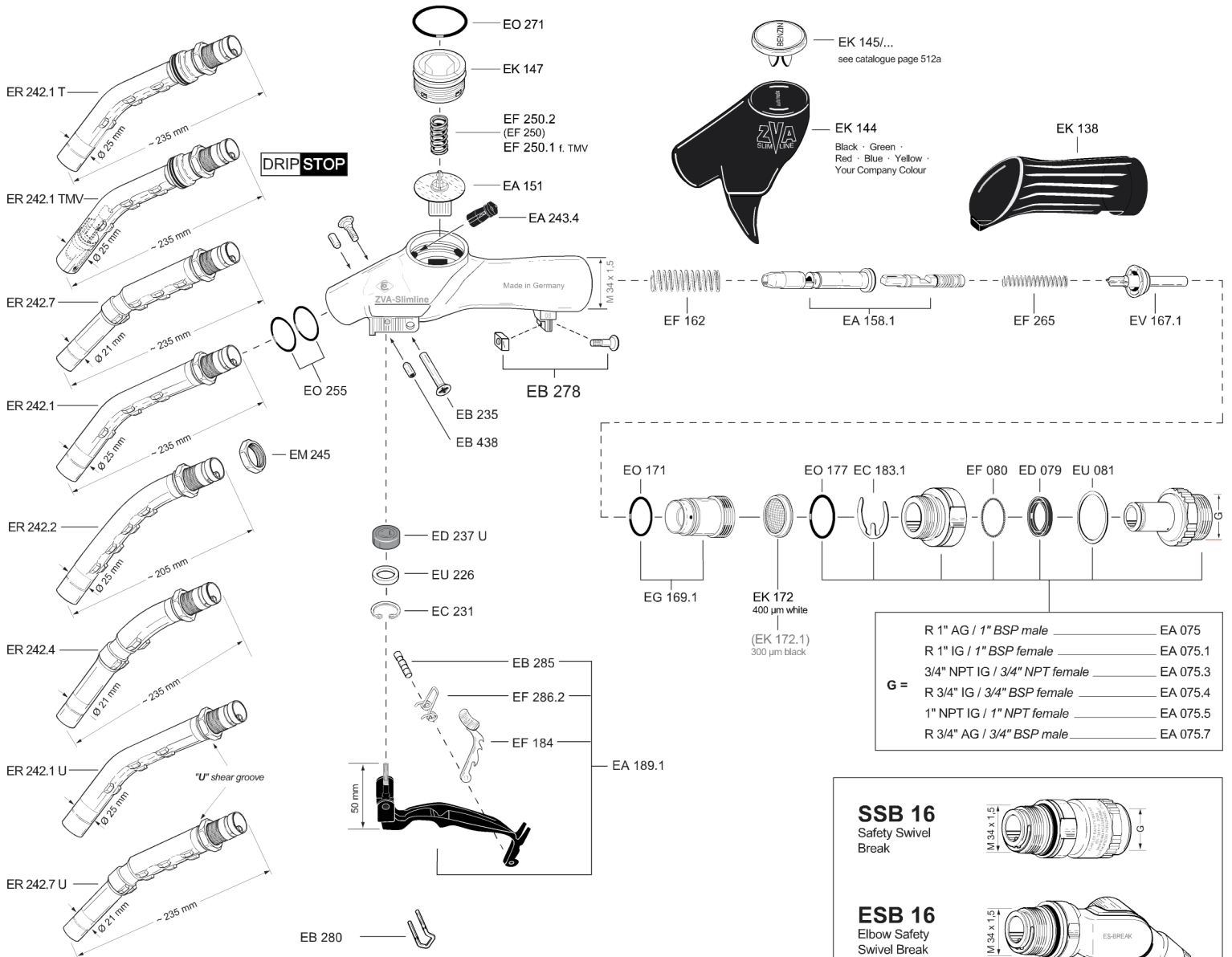

R 1" AG / 1" BSP male	EA 075
R 1" IG / 1" BSP female	EA 075.1
3/4" NPT IG / 3/4" NPT female	EA 075.3
R 3/4" IG / 3/4" BSP female	EA 075.4
1" NPT IG / 1" NPT female	EA 075.5
R 3/4" AG / 3/4" BSP male	EA 075.7

G =

SSB 16
Safety Swivel Break

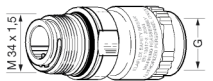

ESB 16
Elbow Safety Swivel Break

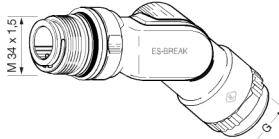

PSB 16
Pump Safety Break
f. High Hose
Dispensers

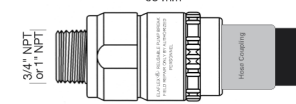

BS 16
Break Sleeve
f. SSB 16 + ESB 16 + PSB 16

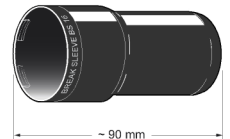

Black (Standard) ·
Green · Red ·
Blue · Yellow ·
Your Company Colour

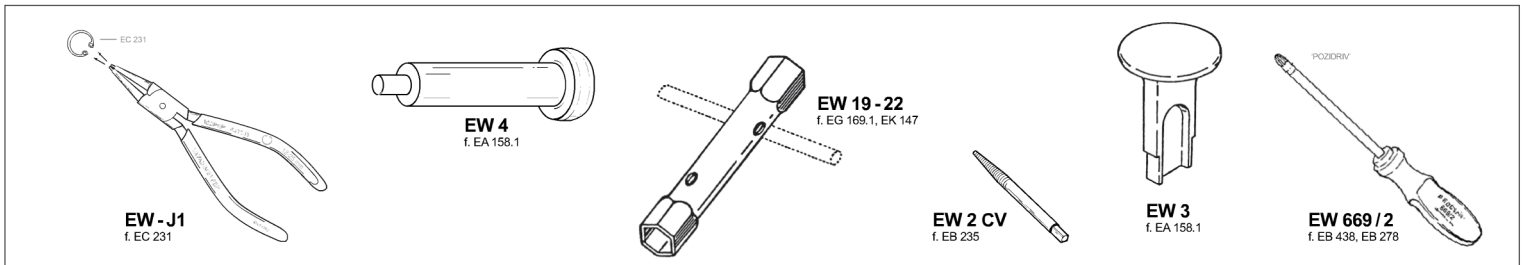

ZVA SLIMLINE 2 (production from 1.2009)

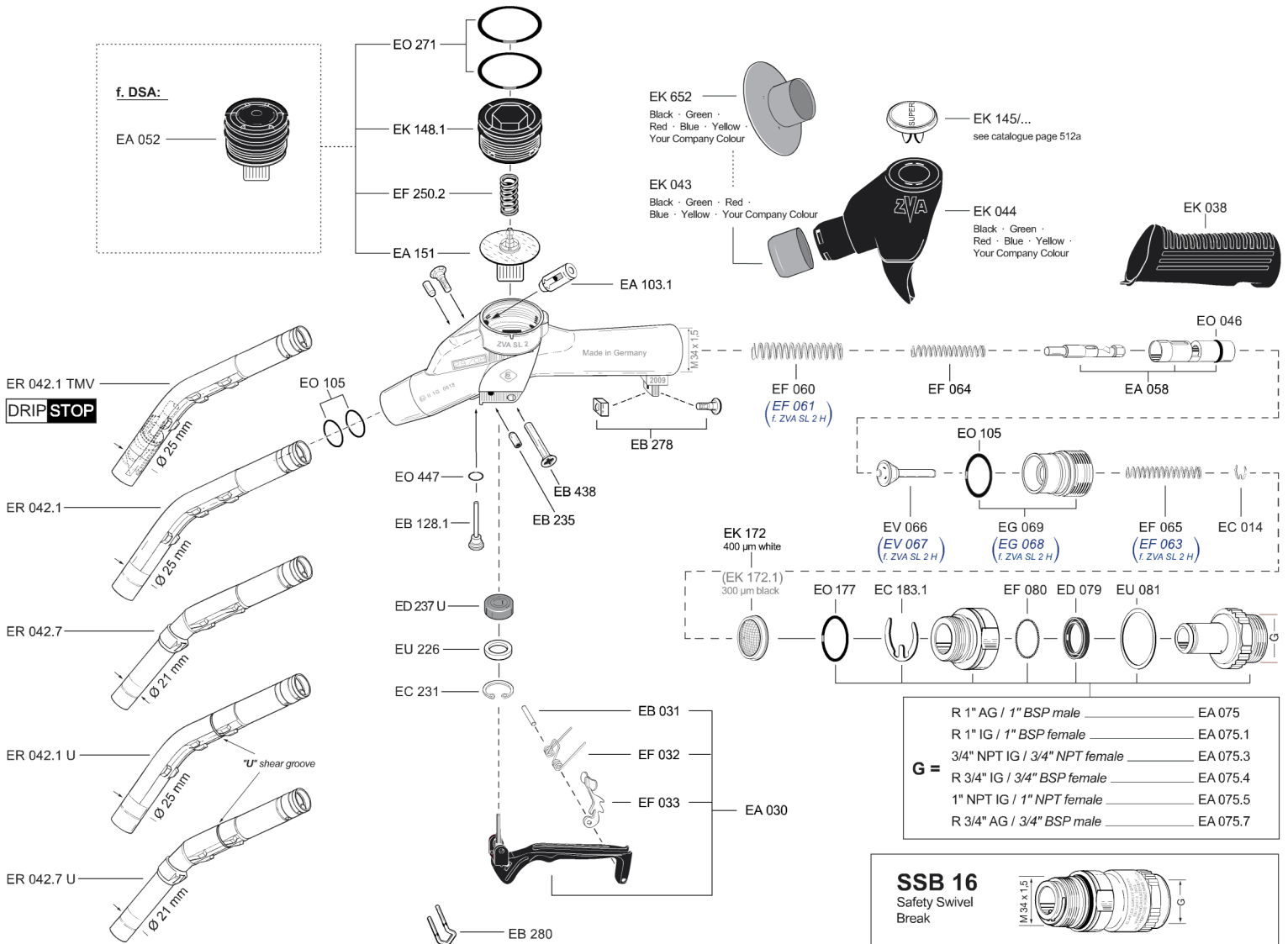

SSB 16

Safety Swivel Break

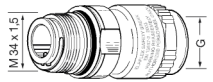

ESB 16

Elbow Safety Swivel Break



PSB 16

Pump Safety Break f. High Hose Dispensers

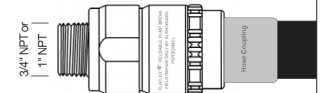

BS 16

Break Sleeve

f. SSB 16 + ESB 16 + PSB 16



Black (Standard) · Green · Red · Blue · Yellow · Your Company Colour

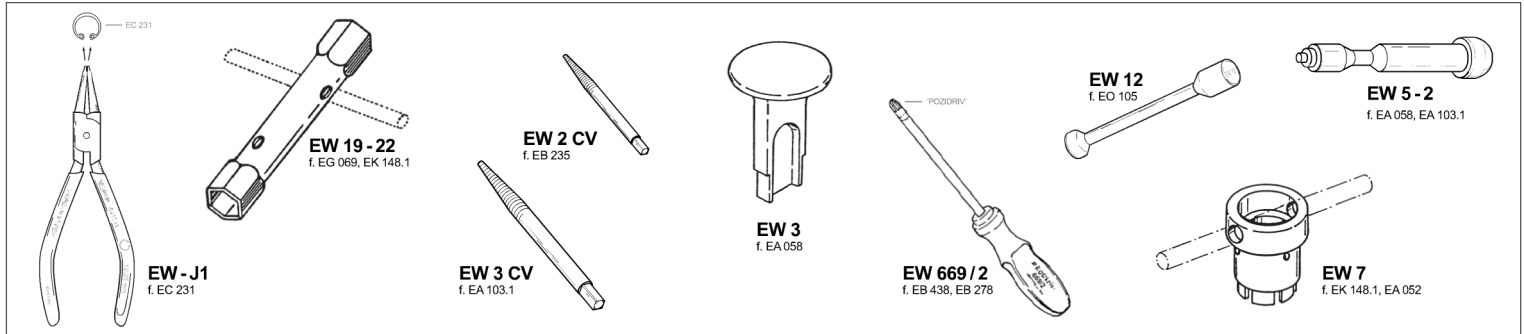



ZVA 25

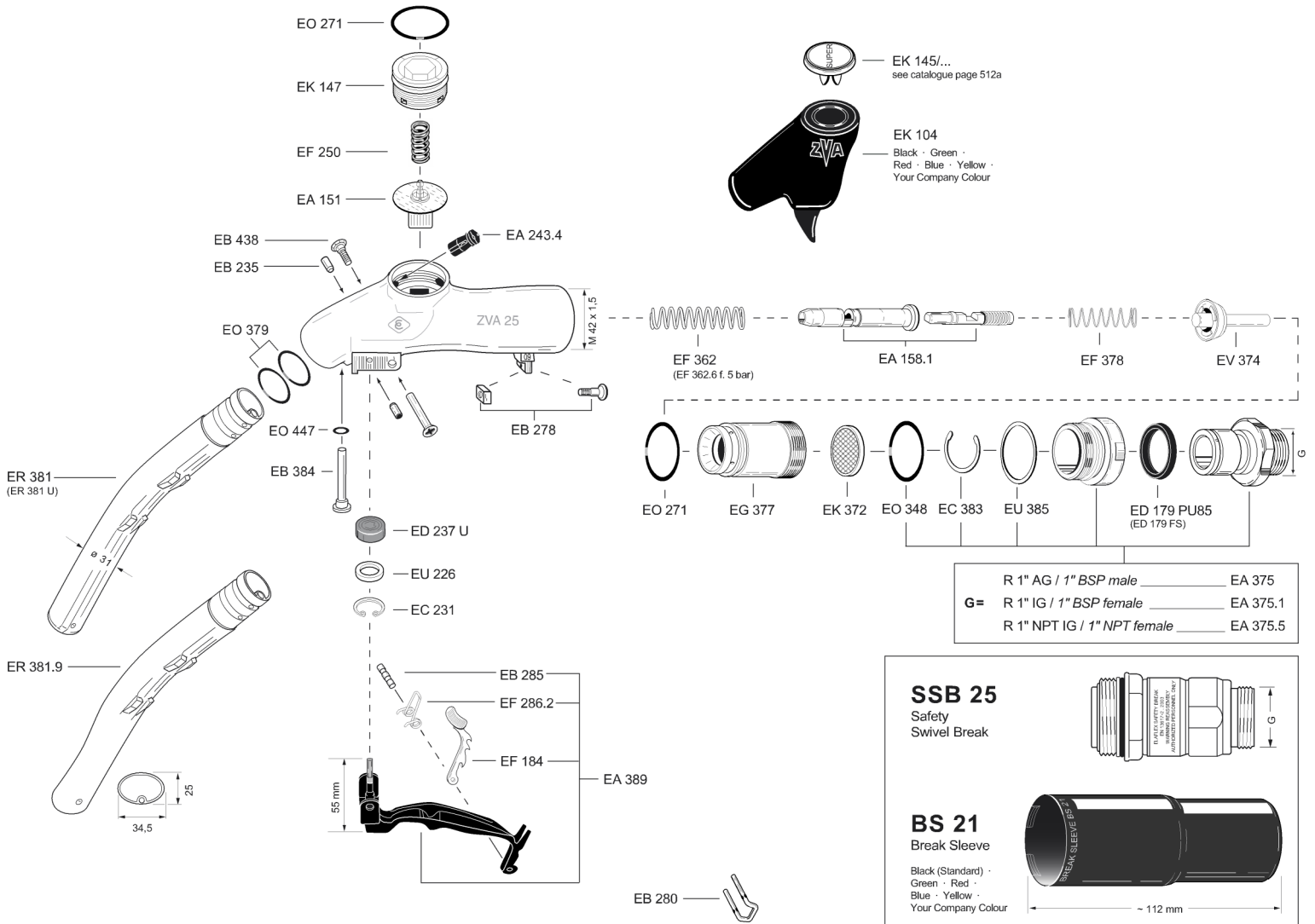

SSB 25
Safety Swivel Break

BS 21
Break Sleeve

Black (Standard) · Green · Red · Blue · Yellow · Your Company Colour

~ 112 mm



f. Aircraft Refuelling

SG 1" cr — ES 239.1 (160 µm / 100 mesh)

EKG 1200 — ES 382 (Spout strainer 1000 µm / 20 mesh)

ER 381 JET — GKG 25

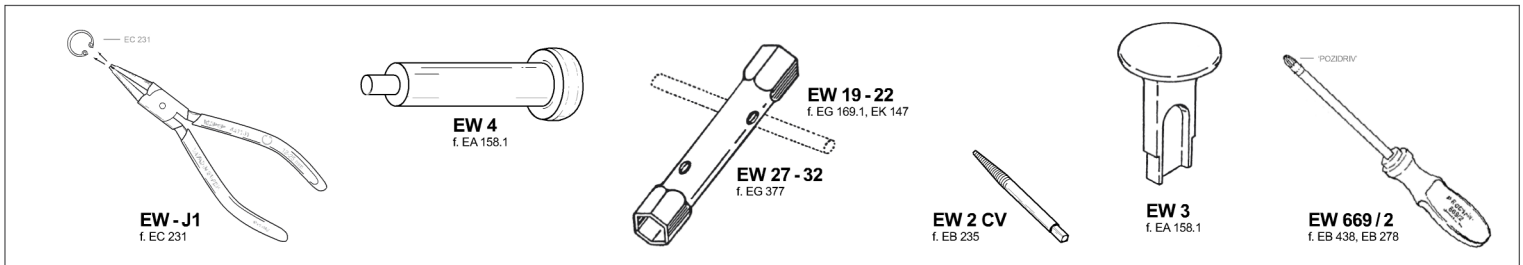

ZVA 32

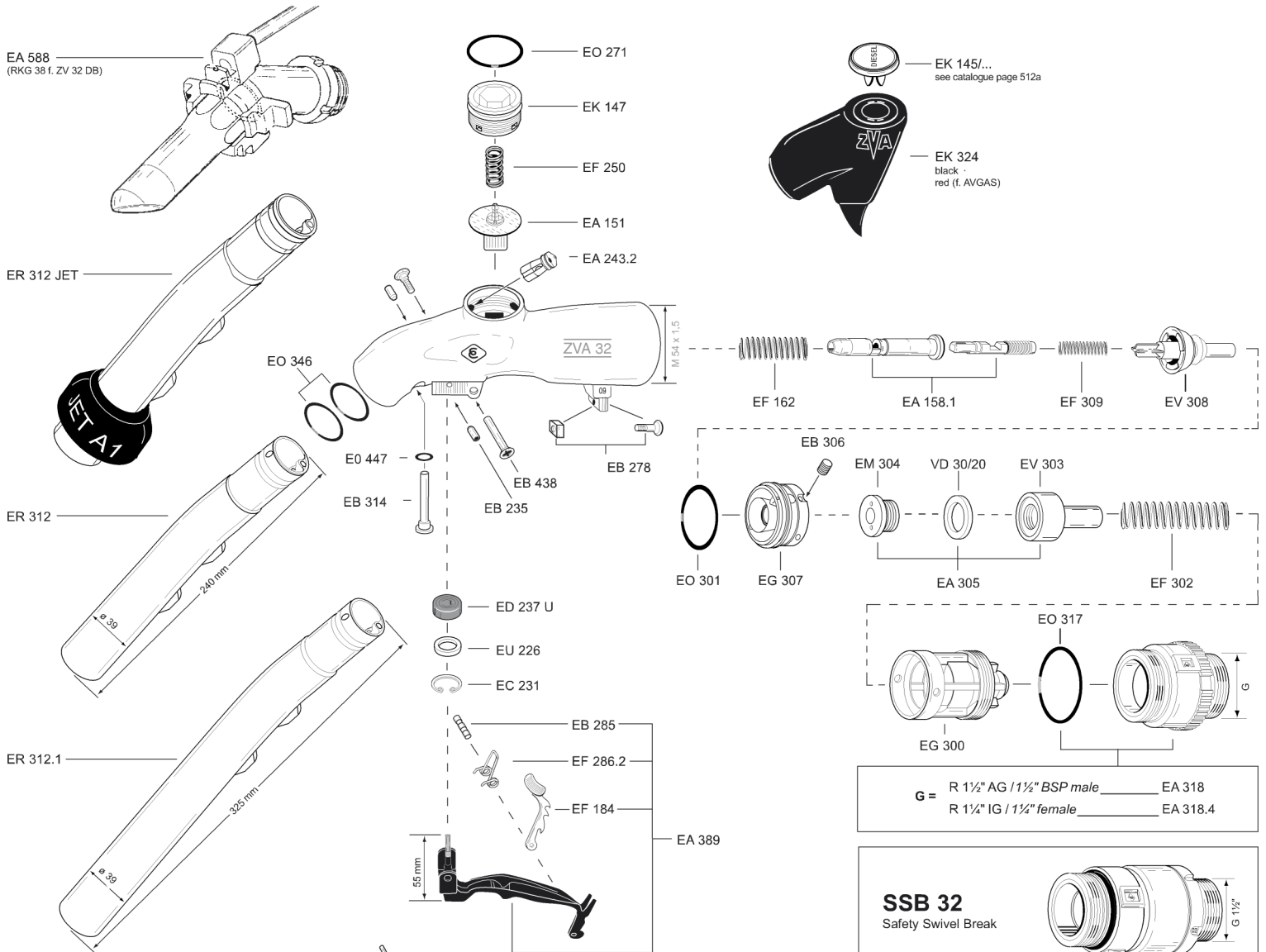

G = R 1½" AG / 1½" BSP male _____ EA 318
 R 1¼" IG / 1¼" female _____ EA 318.4

SSB 32
 Safety Swivel Break



G 1½"

BT 32
 Break Sleeve Black

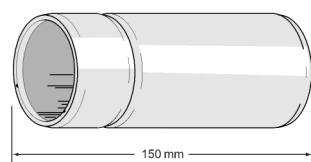

150 mm

RN 2 x M54 x 1,5 Adapter

DDC - V 50 2" AL Dry Disconnect Coupling

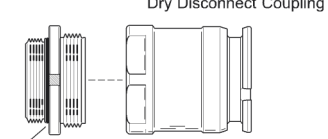

EO 317

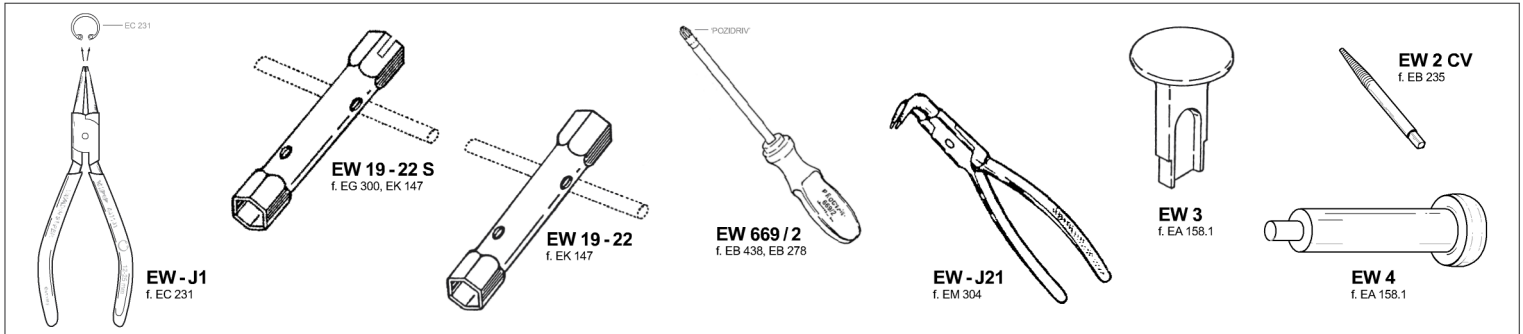
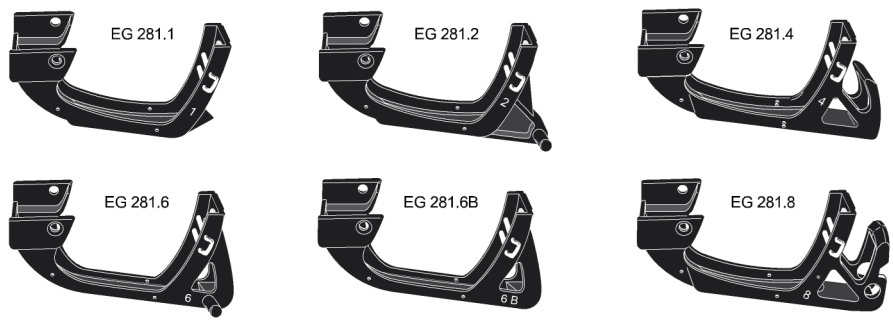

ZVA 200 GR (production until 12.2008)

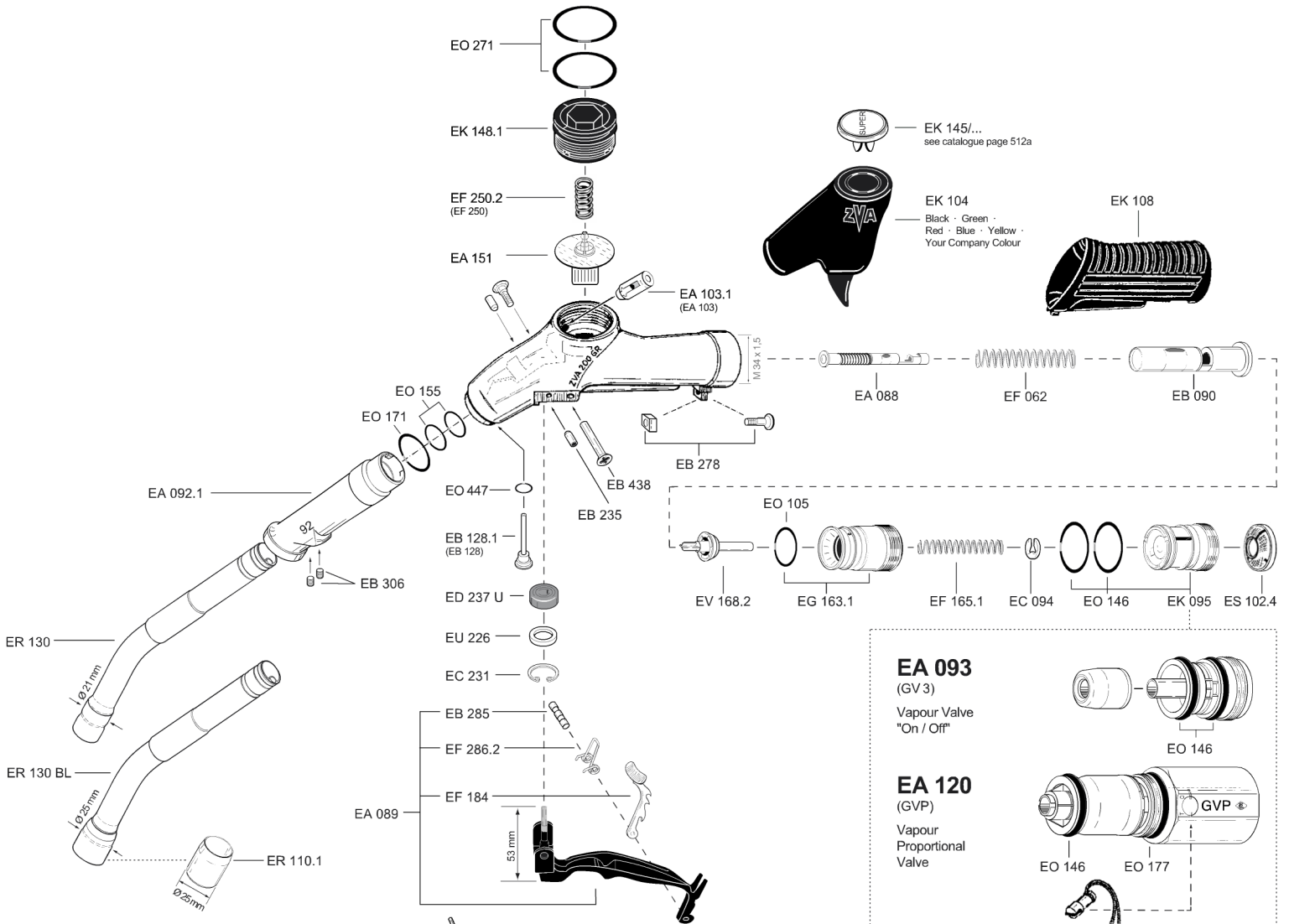

EA 093

(GV 3)
Vapour Valve
"On / Off"

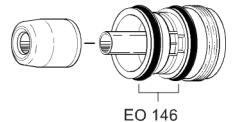

EA 120

(GVP)
Vapour
Proportional
Valve

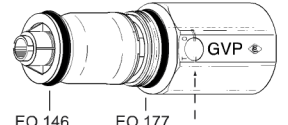

EW-T

f. GVP

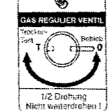

s. Info 5.95

CSB 21

COAX Safety Break

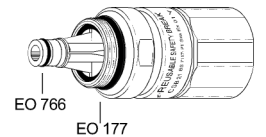

BS 21

Break Sleeve
f. CSB 21

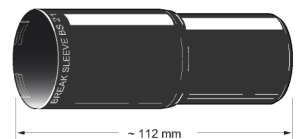

Black (Standard) ·
Green · Red ·
Blue · Yellow ·
Your Company Colour

~ 112 mm



EG 281.1



EG 281.3



EG 281.3M

M = Magnet



EG 281.4

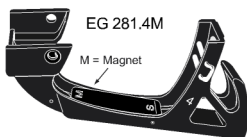

EG 281.4M

M = Magnet

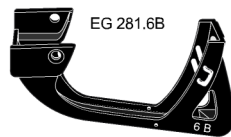

EG 281.6B

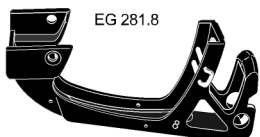

EG 281.8

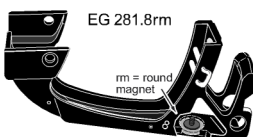

EG 281.8rm

rm = round magnet

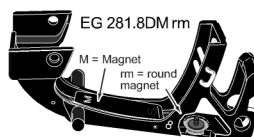

EG 281.8DM rm

M = Magnet
rm = round magnet

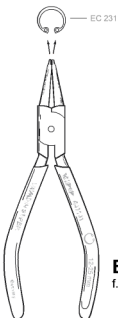

EW-J1
f. EC 231

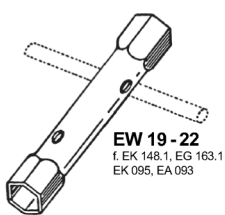

EW 19-22
f. EK 148.1, EG 163.1
EK 095, EA 093



EW 3 CV
f. EB 103.1

EW 2 CV
f. EB 235

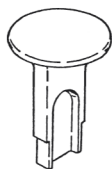

EW 3
f. EA 088, EB 090



EW 669/2
f. EB 438, EB 278



EW 5-2
f. EB 090, EA 103.1

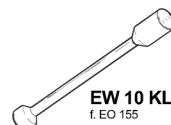

EW 10 KL
f. EO 155

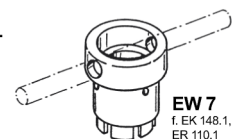

EW 7
f. EK 148.1,
ER 110.1

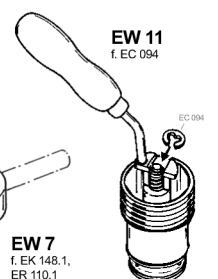

EW 11
f. EC 094

ZVA SLIMLINE 2 GR (production from 1.2009)

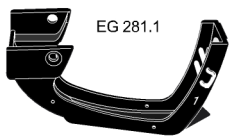
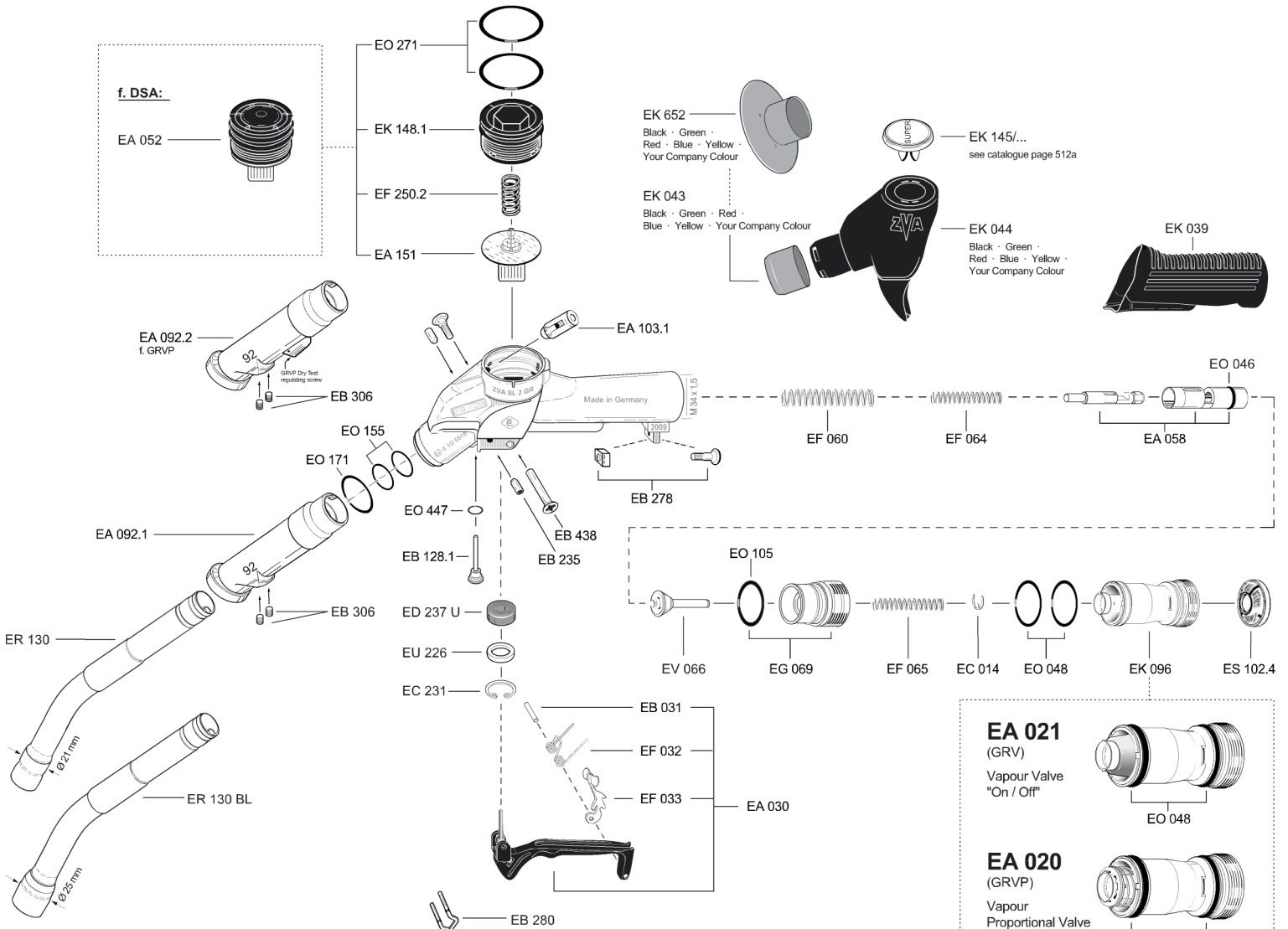

EG 281.1

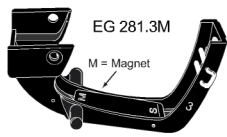

EG 281.3M
M = Magnet

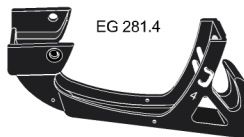

EG 281.4

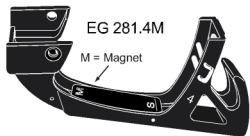

EG 281.4M
M = Magnet

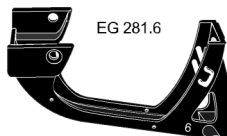

EG 281.6

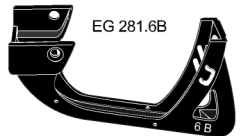

EG 281.6B

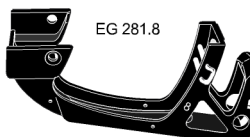

EG 281.8

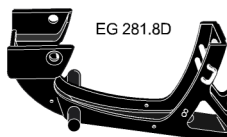

EG 281.8D

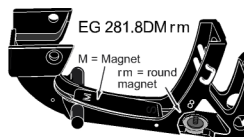

EG 281.8DMrm
M = Magnet
rm = round magnet

CSB 21
COAX Safety Break

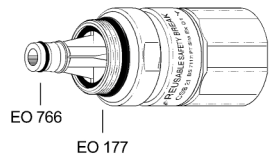

BS 21
Break Sleeve
f. CSB 21

Black (Standard) ·
Green · Red ·
Blue · Yellow ·
Your Company Colour

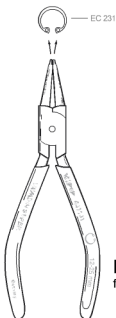
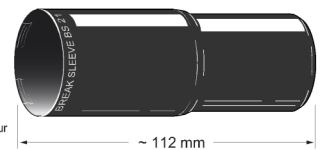

EW-J1
f. EC 231

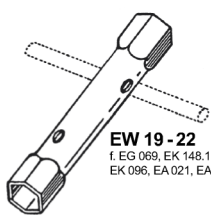

EW 19-22
f. EG 069, EK 148.1,
EK 096, EA 021, EA 020

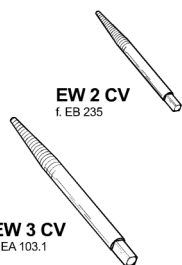

EW 2 CV
f. EB 235

EW 3 CV
f. EA 103.1

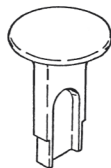

EW 3
f. EA 058



EW 669/2
f. EB 438, EB 278

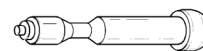

EW 5-2
f. EA 058, EA 103.1

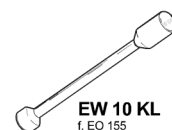

EW 10 KL
f. EO 155

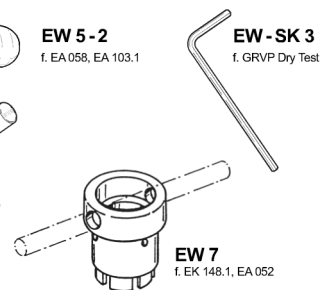

EW 7
f. EK 148.1, EA 052

EW-SK 3
f. GRVP Dry Test